

B-Puffer

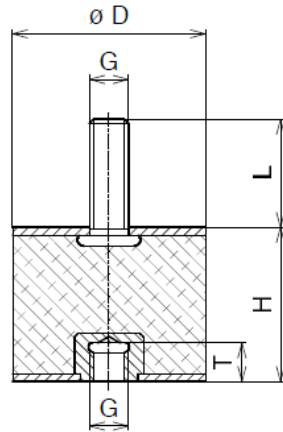

Standardware / Standard Items **Anfertigungsware** / Non-Standard Items

| Abmessungen/ Dimensions | | | | Weitere kurzfristig lieferbare Gewindelängen. Additional threads available on short notice. | | Edelstahl/ Stainless Steel |
|----------------------------|-----------|-----------|-----------|--|--------------------------|----------------------------------|
| mm (D) x (H) | mm (G) | mm (L) | mm (T) | mm (G) | mm (L) | mm (L) |
| 6 x 6 | M3 | 6 | 3 | M3 | 3 | |
| 6 x 7 | | | | | | |
| 8 x 6 | M3 | 6 | 3 | M3 | 3, 4, 5 | 6 |
| 8 x 8 | | | | | | |
| 8 x 10 | | | | | | |
| 10 x 8 | M4 | 10 | 3 | M3 | 2, 5, 3, 5, 6, 10 | 10 |
| 10 x 10 | | | | M4 | 4, 5, 6, 7, 8, 12, 15 | |
| 10 x 15 | | | | M5 | 6, 8, 10, 12, 16 | |
| 15 x 8 | M4 | 13 | 4 | M4 | 4, 5 | 6, 10, 13 |
| 15 x 10 | | | | M4 | 6, 8, 10, 12, 15 | |
| 15 x 15 | | | | M5 | 6, 8, 10, 12, 15 | |
| 15 x 20 | | | | M6 | 5, 6, 10, 15 | |
| 15 x 25 | | | | | | |
| 15 x 30 | | | | | | |
| 20 x 15 | M6 | 15 | 6 | M4 | 15 | 10, 15 |
| 20 x 20 | | | | M5 | 8, 9, 10, 12, 15, 30 | |
| 20 x 25 | | | | M6 | 8, 10, 12, 15, 20 | |
| 20 x 30 | | | | M8 | 8, 12, 15, 20, 36 | |
| 25 x 15 | M6 | 18 | 6 | M5 | 8, 9, 15 | 10, 16 18 20,23 |
| 25 x 20 | | | | M6 | 6, 8, 10, 12, 15, 16, 20 | |
| 25 x 25 | | | | M6 | 25, 33 | |
| 25 x 30 | | | | M8 | 12, 15, 16, 20, 23, 30 | |
| 25 x 35 | | | | M10 | 25, 28, 33, 53 | |

Standardware in NK 43, 57 und 68 ShA / Standard items in NR 43, 57, 68 ShA

Auf Anfrage / Upon request

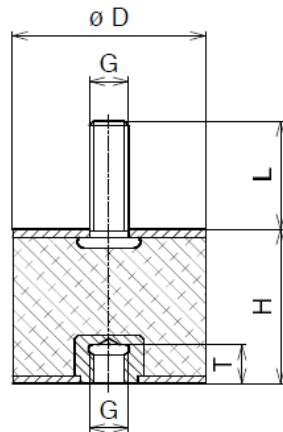

Standardware / Standard Items **Anfertigungsware** / Non-Standard Items

| Abmessungen/ Dimensions | | | | Weitere kurzfristig lieferbare Gewindelängen. Additional threads available on short notice. | | Edelstahl/ Stainless Steel |
|----------------------------|-----------|-----------|-----------|--|----------------------------|----------------------------------|
| mm (D) x (H) | mm (G) | mm (L) | mm (T) | mm (G) | mm (L) | mm (L) |
| 30 x 15 | M6 | 18 | 6 | M6 | 15, 18, 20 | 10, 15 20 |
| 30 x 20 | | | | M8 | 8, 10, 13, 15, 16, 18, 23 | |
| 30 x 25 | | | | M8 | 27, 30, 36, 40 | |
| 30 x 30 | | | | M10 | 15, 20, 28, 42 | |
| 30 x 35 | | | | | | |
| 30 x 40 | | | | | | |
| 40 x 15 | M8 | 23 | 8 | M6 | 20, 23 | 23 |
| 40 x 20 | | | | M8 | 8, 10, 12, 16, 18, 20 | |
| 40 x 25 | | | | M8 | 27, 36, 40 | |
| 40 x 30 | | | | M10 | 10, 13, 18, 20, 28 | |
| 40 x 35 | | | | M12 | 28, 30 | |
| 40 x 40 | | | | | | |
| 50 x 20 | M10 | 28 | 10 | M8 | 10, 12, 20, 36 | 15, 23 28 |
| 50 x 25 | | | | M10 | 10, 12, 15, 17, 20, 25, 33 | |
| 50 x 30 | | | | M10 | 36, 40, 50, 60 | |
| 50 x 40 | | | | M12 | 20, 27, 33, 37 | |
| 50 x 45 | | | | | | |
| 50 x 50 | | | | | | |
| 60 x 25 | M10 | 27 | 10 | M10 | 20, 32 | |
| 60 x 30 | | | | M12 | 20, 22, 27, 33, 37 | |
| 60 x 35 | | | | | | |
| 60 x 40 | | | | | | |
| 60 x 45 | | | | | | |
| 60 x 50 | | | | | | |
| 70 x 40 | M10 | 30 | 10 | M10 | 25 | 30 |
| 70 x 45 | | | | M12 | 27, 37 | |

Standardware in NK 43, 57 und 68 ShA / Standard items in NR 43, 57, 68 ShA

Auf Anfrage / Upon request

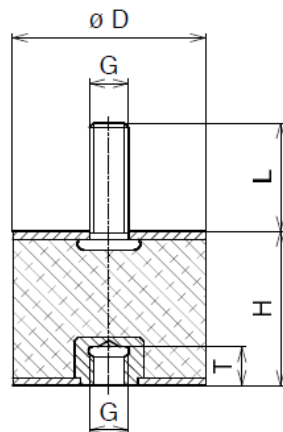

Standardware / Standard Items **Anfertigungsware** / Non-Standard Items

| Abmessungen/ Dimensions | | | | Weitere kurzfristig lieferbare Gewindelängen. Additional threads available on short notice. | | Edelstahl/ Stainless Steel |
|----------------------------|-----------|-----------|-----------|--|--------------------|----------------------------------|
| mm (D) x (H) | mm (G) | mm (L) | mm (T) | mm (G) | mm (L) | mm (L) |
| 75 x 25 | M12 | 37 | 12 | M10 | 38 | 37 |
| 75 x 30 | | | | M12 | 12, 15, 20, 25, 27 | |
| 75 x 40 | | | | M16 | 37, 47 | |
| 75 x 45 | | | | | | |
| 75 x 50 | | | | | | |
| 75 x 55 | | | | | | |
| 75 x 60 | | | | | | |
| 75 x 70 | | | | | | |
| 100 x 30 | M16 | 46 | 16 | M12 | 12, 18, 26, 36 | 46 |
| 100 x 40 | | | | M16 | 21, 26, 36 | |
| 100 x 50 | | | | M20 | 30, 45 | |
| 100 x 55 | | | | | | |
| 100 x 60 | | | | | | |
| 100 x 75 | | | | | | |
| 100 x 100 | | | | | | |
| 125 x 55 | M16 | 46 | 16 | M16 | 25, 36 | |
| 125 x 60 | | | | | | |
| 125 x 65 | | | | | | |
| 125 x 75 | | | | | | |
| 150 x 55 | M16 | 45 | 16 | M16 | 35, 40, 55, 60 | |
| 150 x 60 | | | | M20 | 45, 55, 60 | |
| 150 x 75 | | | | M30 | 50 | |
| 150 x 100 | | | | | | |
| 150 x 200 | | | | | | |
| 200 x 50 | M16 | 45 | 16 | M16 | 30, 40, 55, 60 | |
| 200 x 75 | | | | M20 | 45 | |
| 200 x 100 | | | | | | |

Standardware in NK 43, 57 und 68 ShA / Standard items in NR 43, 57, 68 ShA

Auf Anfrage / Upon request