

Standardware / Standard Items **Anfertigungsware** / Non-Standard Items

Abmessungen/ Dimensions			Weitere kurzfristig lieferbare Gewindelängen. Additional threads available on short notice.		Edelstahl/ Stainless Steel
mm (D) x (H)	mm (G)	mm (L)	mm (G)	mm (L)	mm (L)
4 x 6	M2	6			
6 x 6	M3	6	M3	3	
6 x 7	M3	6			
8 x 6			M3	3, 4, 5	6
8 x 8	M3	6			
8 x 10			M4	8, 10, 12	
9 x 12	M4	10			
10 x 8			M3	2.5, 3.5, 6, 10	
10 x 10	M4		M4	4, 5, 6, 7, 8, 12, 15	10
10 x 15			M5	6, 8, 10, 12, 16	
15 x 6			M4	4, 5	6, 10, 13
15 x 8		10	M4	6, 8, 10, 12, 15	
15 x 10			M5	6, 8, 10, 12, 15	
15 x 15	M4	13	M6	5, 6, 10, 15	
15 x 20		13			
15 x 25					
15 x 30					
18 x 8.5	M6	16	M5	6	
			M6	6, 8, 10, 12, 14, 19, 25, 38	
20 x 8			M4	15	
20 x 10			M5	8, 9, 10, 12, 15, 30	
20 x 15	M6	15	M6	8, 10, 12, 18, 20	10, 15
20 x 20			M8	8, 12, 15, 20, 36	
20 x 25					
20 x 30					

Standardware in NK 43, 57 und 68 ShA / Standard items in NR 43, 57, 68 ShA

Auf Anfrage / Upon request

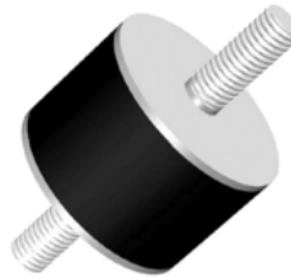
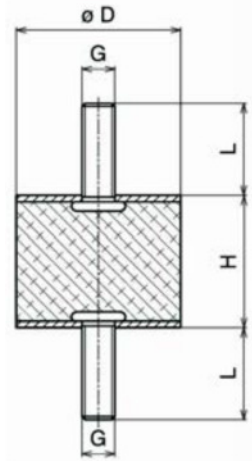

Standardware / Standard Items **Anfertigungsware** / Non-Standard Item

Abmessungen/ Dimensions			Weitere kurzfristig lieferbare Gewindelängen. Additional threads available on short notice.		Edelstahl/ Stainless Steel
mm (D) x (H)	mm (G)	mm (L)	mm (G)	mm (L)	mm (L)
25 x 10	M6	18	M5	8, 9, 15	10, 16 18
25 x 15			M6	6, 8, 10, 12, 15, 16, 20	
25 x 20			M6	25, 33	
25 x 25			M8	12, 15, 16, 20, 23, 30	
25 x 30			M10	25, 28, 33, 53	
25 x 35					
30 x 15	M8	20	M6	15, 18, 20	10, 15 20
30 x 20			M8	8, 10, 13, 15, 16, 18, 23	
30 x 25			M8	27, 30, 36, 40	
30 x 30			M10	15, 20, 28, 42	
30 x 35					
30 x 40					
40 x 15	M8	23	M6	20, 23	23
40 x 20			M8	8, 10, 12, 16, 18, 20	
40 x 25			M8	27, 36, 40	
40 x 30			M10	10, 13, 18, 20, 28	
40 x 35			M12	28, 30	
40 x 40					
50 x 20	M10	28	M8	10, 12, 20, 36	15, 23 28
50 x 25			M10	10, 12, 15, 17, 20, 25, 33	
50 x 30			M10	36, 40, 50, 60	
50 x 35			M12	20, 27, 33, 37	
50 x 40					
50 x 45					
50 x 50					

Standardware in NK 43, 57 und 68 ShA / Standard items in NR 43, 57, 68 ShA

Auf Anfrage / Upon request

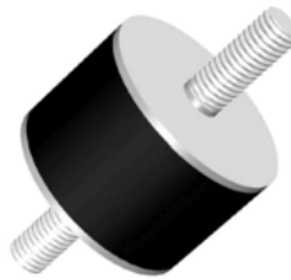
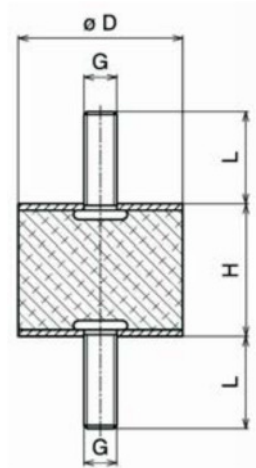

Standardware / Standard Items **Anfertigungsware** / Non-Standard Item

Abmessungen/ Dimensions			Weitere kurzfristig lieferbare Gewindelängen. Additional threads available on short notice.		Edelstahl/ Stainless Steel
mm (D) x (H)	mm (G)	mm (L)	mm (G)	mm (L)	mm (L)
60 x 25	M10	27	M10	20, 32	
60 x 30			M12	20, 22, 27, 33, 37	
60 x 35					
60 x 40					
60 x 45					
60 x 50					
70 x 40	M10	30	M10	25	30
70 x 45			M12	27,37	
75 x 25	M12	37	M10	38	37
75 x 30			M12	12, 15, 20, 25, 27	
75 x 40			M16	37, 47	
75 x 45					
75 x 50					
75 x 55					
75 x 60					
75 x 70					
100 x 30	M16	46	M12	12, 18, 26, 36	46
100 x 40			M16	21, 26, 36	
100 x 50			M20	30, 45	
100 x 55					
100 x 60					
100 x 75					
100 x 100					

Standardware in NK 43, 57 und 68 ShA / Standard items in NR 43, 57, 68 ShA

Auf Anfrage / Upon request

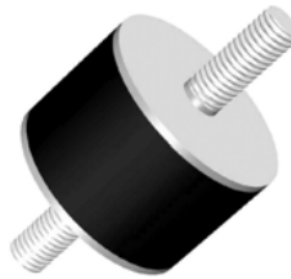
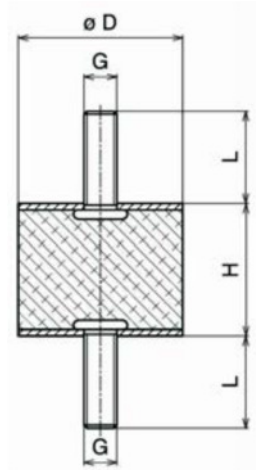

Standardware / Standard Items **Anfertigungsware** / Non-Standard Item

Abmessungen/ Dimensions			Weitere kurzfristig lieferbare Gewindelängen. Additional threads available on short notice.		Edelstahl/ Stainless Steel
mm (D) x (H)	mm (G)	mm (L)	mm (G)	mm (L)	mm (L)
125 x 55 125 x 60 125 x 65 125 x 75	M16	46	M16	25, 36	
150 x 55 150 x 60 150 x 75 150 x 100 150 x 200	M16	45	M16 M20 M30	35, 40, 55, 60 45, 60 50	
200 x 50 200 x 75 200 x 100	M16 M16 M16	45	M16 M20	30, 40, 55, 60 45	

Standardware in NK 43, 57 und 68 ShA / Standard items in NR 43, 57, 68 ShA

Auf Anfrage / Upon request