

Zubehör M24x2

GS-70, HB-70, HBS-70

**D24 Gabelkopf
DIN 71752**

¹ bis max. 50 000 N

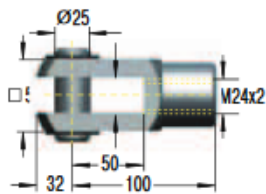

**E24 Gelenkkopf
DIN 648**

¹ bis max. 50 000 N

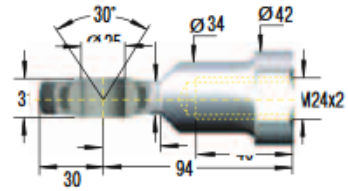

¹ bis max. 50 000 N

ME24

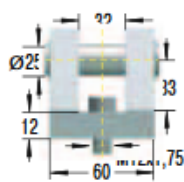
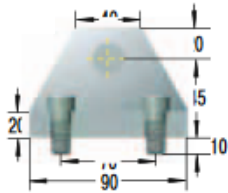

¹ bis max. 50 000 N

ND24

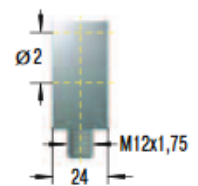
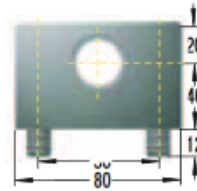

¹ Achtung! Max. statische Belastung in N; Krafterhöhung beim Eindrücken (Progression) beachten. Höhere Belastung auf Anfrage möglich.