

SC²300 to SC²650

Piston tube design for maximum energy absorption

Self-Compensating, Piston Tube Technology
Energy capacity 73 Nm/Cycle to 210 Nm/Cycle
Stroke 15 mm to 23 mm

Added safety with accumulator technology:
 The larger 'soft contact' models from the SC²300 to 650 are available with up to three times the energy absorption compared to similar sizes of standard shock absorbers SC190 to 925, due to the ACE piston tube speciality. Furthermore, the membrane accumulator serves as a compensation element for the oil displaced in the shock absorber and replaces the standard use of absorber materials. This increases process safety even further.

The absorbers, which are perfect for rotary modules for example, are available in progressively stepped effective weight ranges with an integrated positive stop. They are maintenance-free and ready for direct installation. The side load adapter option allows impact angles of up to 25°.

These miniature shock absorbers offer high performance levels with a long service life and are particularly popular for handling, mounting very close to pivots and automation tasks.

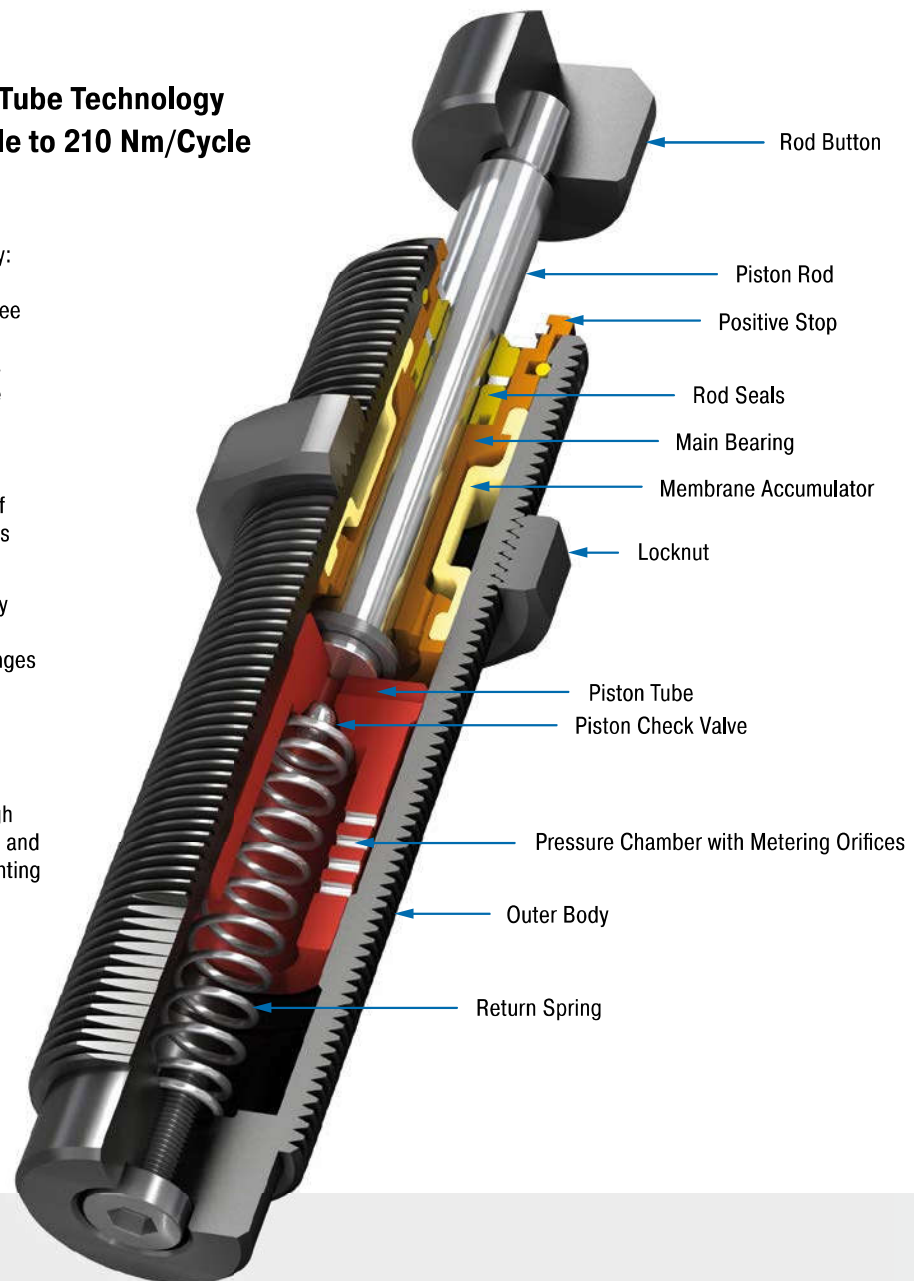

Technical Data

Energy capacity: 73 Nm/Cycle to 210 Nm/Cycle

Impact velocity range: 0.09 m/s to 3.66 m/s. Other speeds on request.

Operating temperature range: 0 °C to 66 °C

Mounting: in any position

Positive stop: Integrated

Material: Outer body: steel corrosion-resistant coating; Piston rod: hardened stainless steel; Accessories: hardened steel and corrosion-resistant coating

Damping medium: oil, temperature stable

Application field: turntables, swivel units, robot arms, linear slides, pneumatic cylinders, handling modules, machines and plants, finishing and processing centres, tool machines

Note: If precise end position datum is required consider use of the stop collar type AH.

On request: Increased corrosion protection. Special finishes.

SC300EUM; 5 to 9

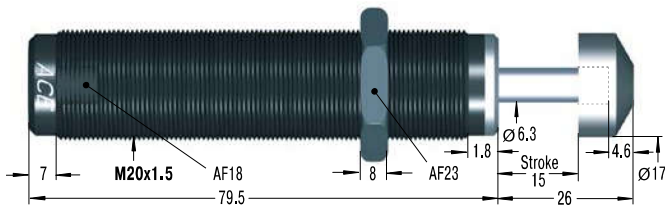

RF20 Rectangular Flange

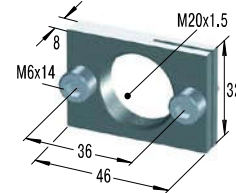

MB20SC2 Mounting Block

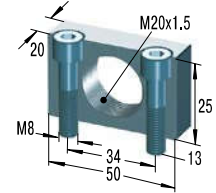

SC650EUM; 5 to 9

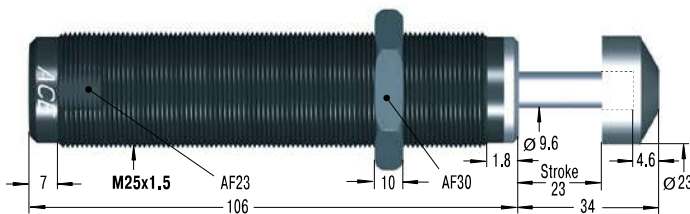

RF25 Rectangular Flange

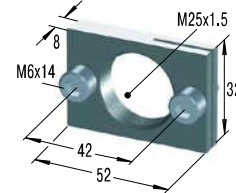

MB25SC2 Mounting Block

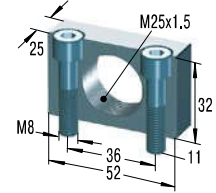

Additional accessories, mounting, installation ... see from page 36.

Performance

TYPES	Max. Energy Capacity		Effective Weight			Side Load Angle				
	W ₃ Nm/cycle	W ₄ Nm/h	me min. kg	me max. kg	Hardness	Return Force min. N	Return Force max. N	Return Time s	max. °	Weight kg
SC300EUM-5	73	45,000	11	45	-5	8	18	0.2	5	0.150
SC300EUM-6	73	45,000	34	136	-6	8	18	0.2	5	0.150
SC300EUM-7	73	45,000	91	181	-7	8	18	0.2	5	0.150
SC300EUM-8	73	45,000	135	680	-8	8	18	0.2	5	0.150
SC300EUM-9	73	45,000	320	1,950	-9	8	18	0.2	5	0.150
SC650EUM-5	210	68,000	23	113	-5	11	33	0.3	5	0.310
SC650EUM-6	210	68,000	90	360	-6	11	33	0.3	5	0.310
SC650EUM-7	210	68,000	320	1,090	-7	11	33	0.3	5	0.310
SC650EUM-8	210	68,000	770	2,630	-8	11	33	0.3	5	0.310
SC650EUM-9	210	68,000	1,800	6,350	-9	11	33	0.3	5	0.310

¹ For applications with higher side load angles consider using the side load adaptor (BV) pages 38 to 45.