

Übersicht

M8x1,25 (für GS-19-VA, GS-22-VA, GZ-19-VA)

G8-VA
Kugelpfanne

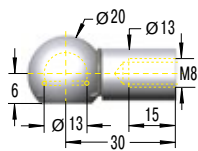

¹ bis max. 1.140 N

NG8-V4A
Winkelbeschlag

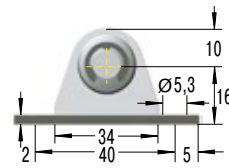

¹ bis max. 1.000 N

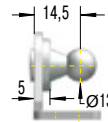

OG8-V4A
Seitenbeschlag

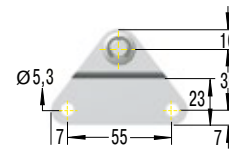

¹ bis max. 1.200 N

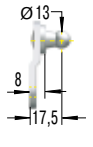

PG8-V4A
Rundbeschlag

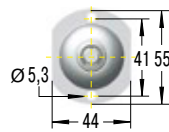

¹ bis max. 1.200 N

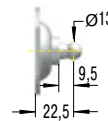

M10x1,5 (für GS-28-VA, GZ-28-VA)

C10-VA
Winkelgelenk

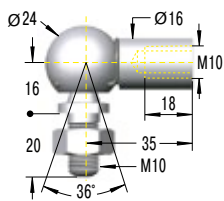

¹ bis max. 1.750 N

D10-VA
Gabelkopf

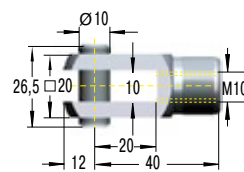

¹ bis max. 3.800 N

E10-VA
Gelenkkopf

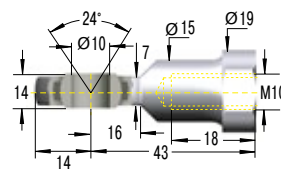

¹ bis max. 3.800 N

A10-VA
Gelenkauge

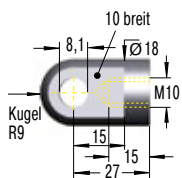

¹ bis max. 3.800 N



MA10-V4A
Lagerschuh

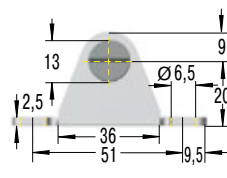

¹ bis max. 1.800 N

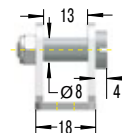

¹Achtung! Max. statische Belastung in N; Krafterhöhung beim Eindrücken (Progression) beachten. Höhere Belastung auf Anfrage möglich.