

Adjustable, Without Free Travel, Compression and extension force 150 N to 50,000 N

End Fitting

Standard Dimensions

End Fitting

B24 M24x2 Thread Adaptor

D24 Clevis Fork **D24** max. force 50,000 N

E24 Swivel Eye **E24** max. force 50,000 N

Stroke: $\varnothing 20$

L +/- 2 mm extended

$\varnothing 85$

Performance and Dimensions

TYPES	Stroke mm	L extended mm	¹ Compression force max. N
HBD-85-100	100	313	50,000
HBD-85-150	150	413	30,000
HBD-85-200	200	513	20,000
HBD-85-300	300	713	10,000
HBD-85-400	400	913	6,500
HBD-85-500	500	1,113	4,000
HBD-85-600	600	1,313	3,000
HBD-85-700	700	1,513	2,000

¹ Max. extension force for all stroke lengths 50,000 N.

Ordering Example

HBD-85-300-EE

Type (Hydraulic Damper) _____

Body \varnothing (85 mm) _____

Stroke (300 mm) _____

Piston Rod End Fitting E24 _____

Body End Fitting E24 _____

Model Type Prefix

P: Damping in both directions (standard model)
 M: Damping on out stroke only (adjustment knob at "rear end" free flow)
 N: Damping on in stroke only (adjustment knob at "piston rod end" free flow)

Mounting accessories see from page 200.

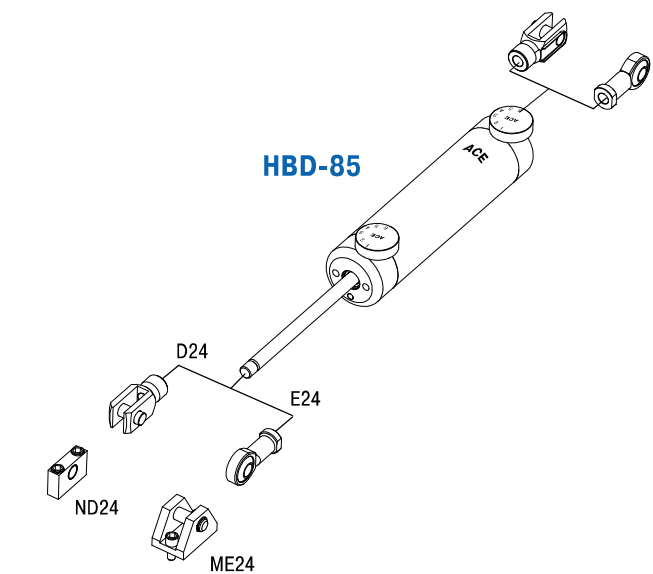

Technical Data

Compression and extension force: 150 N to 50,000 N

Operating temperature range: 0 °C to 65 °C

Adjustment: Steplessly adjustable

Positive stop: External positive stops 2 mm to 3 mm before the end of stroke provided by the customer.

Material: Outer body: Coated steel; Piston rod: Hard chrome plated steel; End fittings: Zinc plated steel

Mounting: In any position

Note: Increased break-away force if unit has not moved for some time. Thread adaptor for piston rod from M16 to M24 included.

End fittings: They are interchangeable and if necessary must be positively secured by the customer to prevent unscrewing.