

Valve Technology, Traction force 500 N to 5,000 N (extended up to 7,250 N)

End Fitting

Standard Dimensions

End Fitting

A14

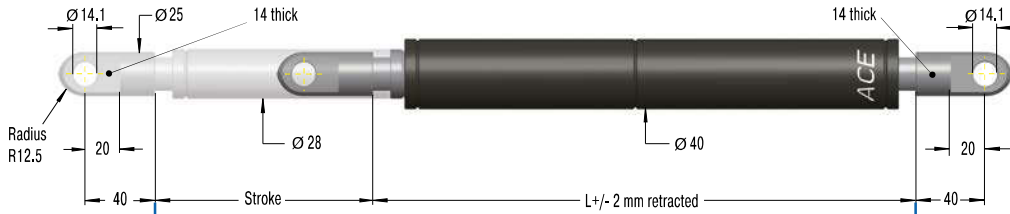

Eye A14
max. force 10,000 N

B14

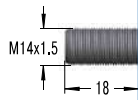

Performance and Dimensions

| TYPES | Stroke mm | L retracted mm | Traction force max. N |
|-----------|--------------|-------------------|--------------------------|
| GZ-40-100 | 100 | 250 | 5,000 |
| GZ-40-150 | 150 | 325 | 5,000 |
| GZ-40-200 | 200 | 400 | 5,000 |
| GZ-40-250 | 250 | 475 | 5,000 |
| GZ-40-300 | 300 | 550 | 5,000 |
| GZ-40-400 | 400 | 700 | 5,000 |
| GZ-40-500 | 500 | 850 | 5,000 |
| GZ-40-600 | 600 | 1,000 | 5,000 |

Stud Thread B14

C14

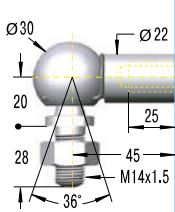

Angle Ball Joint C14
max. force 3,200 N

D14

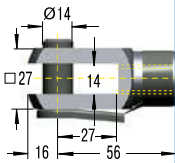

Clevis Fork D14
max. force 10,000 N

E14

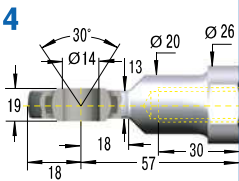

Swivel Eye E14
max. force 10,000 N

Ordering Example

GZ-40-150-EE-800

- Type (Pull Type) _____
- Body Ø (40 mm) _____
- Stroke (150 mm) _____
- Piston Rod End Fitting E14 _____
- Body End Fitting E14 _____
- Traction Force F_1 800 N _____

Mounting accessories see from page 200.

Rod Shroud W14-40

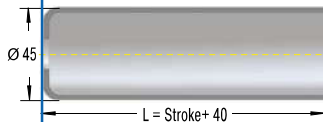

Adjuster Knob DE-GAS-14

See page 175.

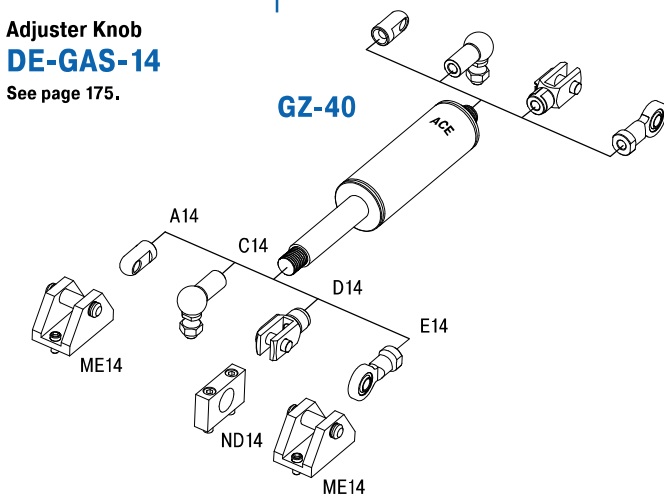

Technical Data

Traction force: 500 N to 5,000 N (extended up to 7,250 N)

Progression: Approx. 43 % to 45 %

Lifetime: Approx. 2,000 m

Operating temperature range: -20 °C to +80 °C

Material: Outer body, End fittings: zinc plated steel; Piston rod: steel with wear-resistant coating

Mounting: with piston rod upwards

End position damping length: Without damping. For end position damping use damping material (e.g. TUBUS or SLAB).

Positive stop: External positive stop at the end of stroke provided by the customer.

End fittings: They are interchangeable and if necessary must be positively secured by the customer to prevent unscrewing.