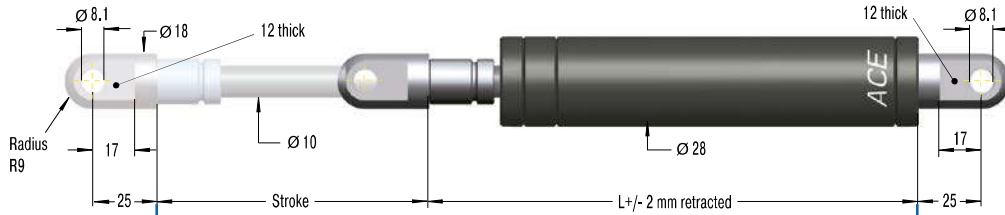
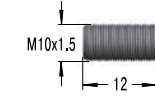
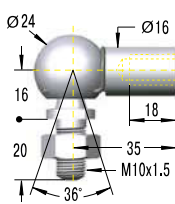

Valve Technology, Traction force 150 N to 1,200 N (extended up to 1,560 N)

**End Fitting**
**Standard Dimensions**
**End Fitting**
**A10**

**Eye A10**  
max. force 10,000 N

**B10**

**Performance and Dimensions**

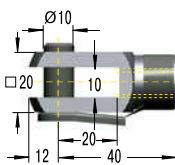
TYPES	Stroke mm	L retracted mm	Traction force max. N
GZ-28-30	30	130	1,200
GZ-28-50	50	150	1,200
GZ-28-100	100	200	1,200
GZ-28-150	150	250	1,200
GZ-28-200	200	300	1,200
GZ-28-250	250	350	1,200
GZ-28-300	300	400	1,200
GZ-28-350	350	450	1,200
GZ-28-400	400	500	1,200
GZ-28-450	450	550	1,200
GZ-28-500	500	600	1,200
GZ-28-550	550	650	1,200
GZ-28-600	600	700	1,200
GZ-28-650	650	750	1,200

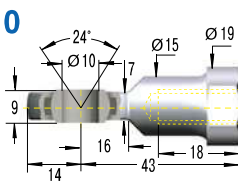
**Stud Thread B10**
**C10**

**Angle Ball Joint C10**  
max. force 1,800 N

**D10**

**Clevis Fork D10**  
max. force 10,000 N

**E10**

**Swivel Eye E10**  
max. force 10,000 N

**Ordering Example**
**GZ-28-150-EE-800**

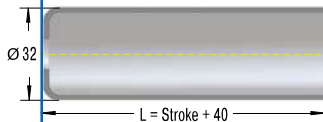
Type (Pull Type) \_\_\_\_\_  
 Body Ø (28 mm) \_\_\_\_\_  
 Stroke (150 mm) \_\_\_\_\_  
 Piston Rod End Fitting E10 \_\_\_\_\_  
 Body End Fitting E10 \_\_\_\_\_  
 Traction Force F<sub>1</sub> 800 N \_\_\_\_\_

Mounting accessories see from page 200.

**Rod Shroud W10-28**

**Adjuster Knob DE-GAS-10**

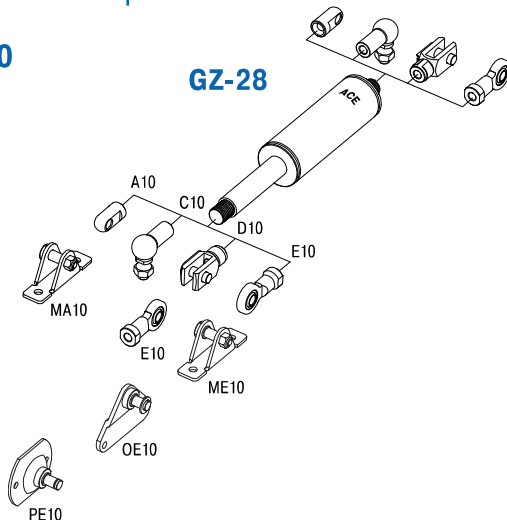
See page 175.

**GZ-28**

**Technical Data**
**Traction force:** 150 N to 1,200 N (extended up to 1,560 N)

**Progression:** Approx. 28 % to 30 %

**Lifetime:** Approx. 2,000 m

**Operating temperature range:** -20 °C to +80 °C

**Material:** Outer body, End fittings: zinc plated steel; Piston rod: steel with wear-resistant coating

**Mounting:** with piston rod upwards

**End position damping length:** Without damping. For end position damping use damping material (e.g. TUBUS or SLAB).

**Positive stop:** External positive stop at the end of stroke provided by the customer.

**End fittings:** They are interchangeable and if necessary must be positively secured by the customer to prevent unscrewing.