

Valve Technology, Traction force 40 N to 350 N (extended up to 448 N)

End Fitting

Standard Dimensions

End Fitting

A8

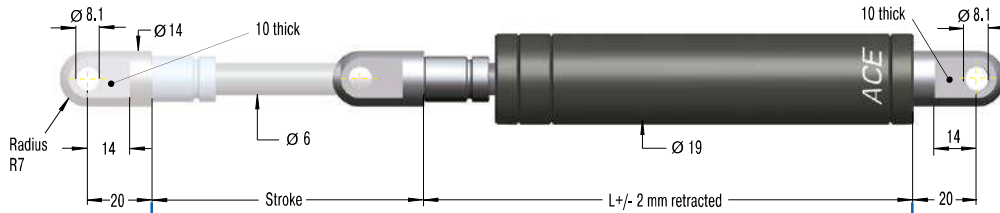

Eye A8
max. force 3,000 N

B8

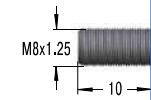

Stud Thread B8

C8

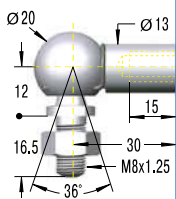

Angle Ball Joint C8
max. force 1,200 N

D8

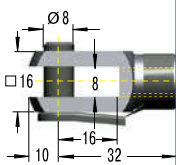

Clevis Fork D8
max. force 3,000 N

E8

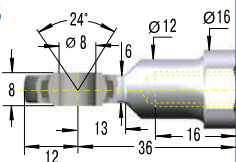

Swivel Eye E8
max. force 3,000 N

G8

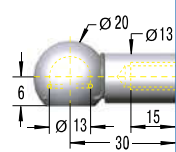

Ball Socket G8
max. force 1,200 N

Performance and Dimensions

TYPES	Stroke mm	L retracted mm	Traction force max. N
GZ-19-30	30	112	350
GZ-19-50	50	132	350
GZ-19-100	100	182	350
GZ-19-150	150	232	350
GZ-19-200	200	282	350
GZ-19-250	250	332	350

Ordering Example

GZ-19-150-AC-250

- Type (Pull Type)
- Body Ø (19 mm)
- Stroke (150 mm)
- Piston Rod End Fitting A8
- Body End Fitting C8
- Traction Force F₁ 250 N

Mounting accessories see from page 200.

Rod Shroud W8-19

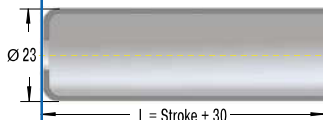

Adjuster Knob DE-GAS-8

See page 175.

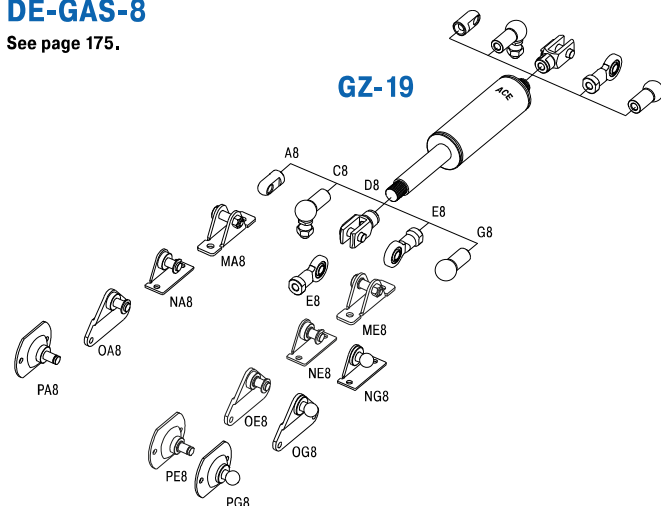

Technical Data

- Traction force:** 40 N to 350 N (extended up to 448 N)
- Progression:** Approx. 21 % to 28 %
- Lifetime:** Approx. 2,000 m
- Operating temperature range:** -20 °C to +80 °C
- Material:** Outer body, End fittings: zinc plated steel; Piston rod: steel with wear-resistant coating
- Mounting:** with piston rod upwards
- End position damping length:** Without damping. For end position damping use damping material (e.g. TUBUS or SLAB).
- Positive stop:** External positive stop at the end of stroke provided by the customer.
- End fittings:** They are interchangeable and if necessary must be positively secured by the customer to prevent unscrewing.