

Valve Technology, Stainless Steel, Traction force 40 N to 350 N (extended up to 448 N)

End Fitting

Standard Dimensions

End Fitting

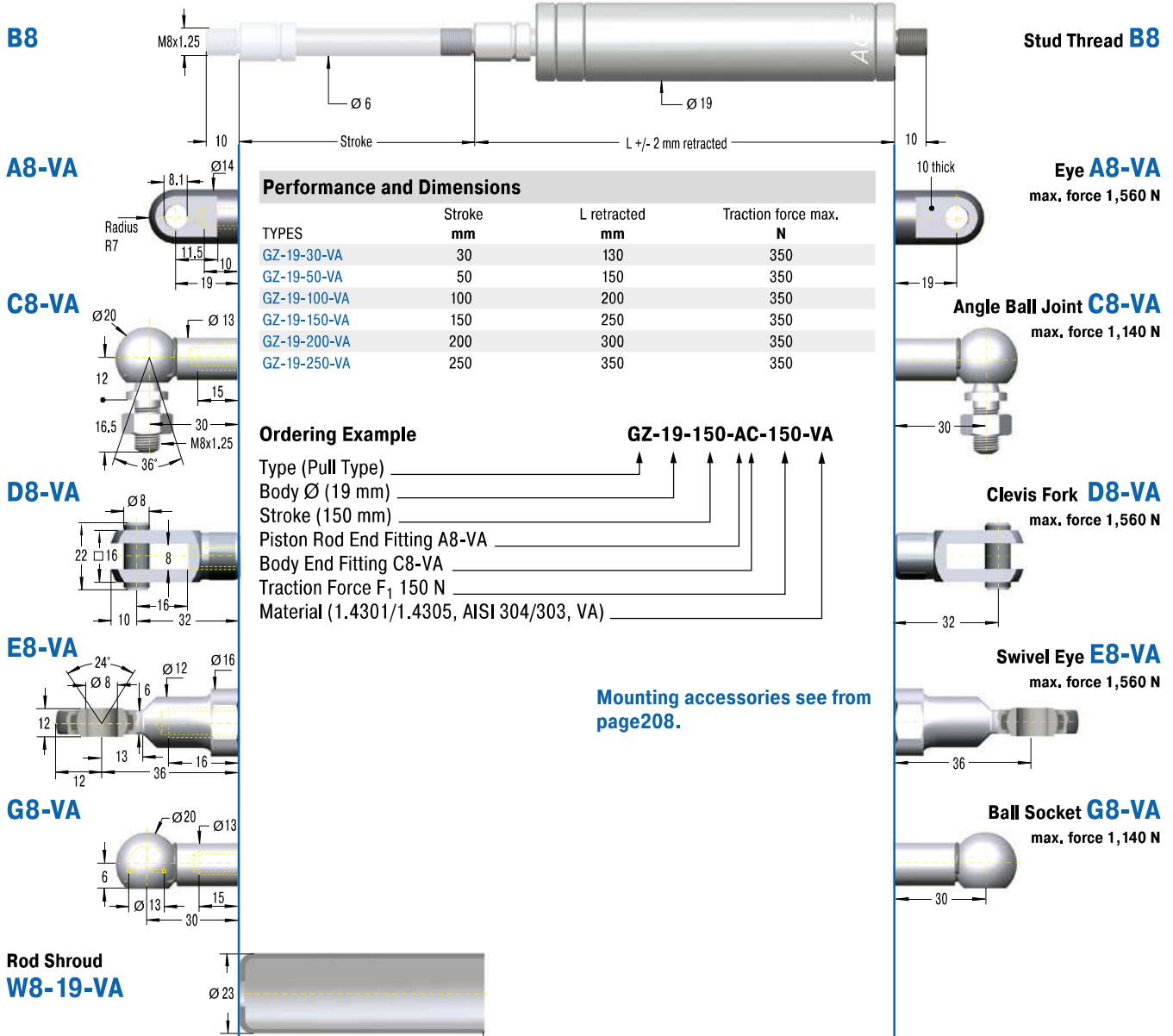

Performance and Dimensions

TYPES	Stroke mm	L retracted mm	Traction force max. N
GZ-19-30-VA	30	130	350
GZ-19-50-VA	50	150	350
GZ-19-100-VA	100	200	350
GZ-19-150-VA	150	250	350
GZ-19-200-VA	200	300	350
GZ-19-250-VA	250	350	350

Ordering Example

GZ-19-150-AC-150-VA

Type (Pull Type) _____
 Body Ø (19 mm) _____
 Stroke (150 mm) _____
 Piston Rod End Fitting A8-VA _____
 Body End Fitting C8-VA _____
 Traction Force F₁ 150 N _____
 Material (1.4301/1.4305, AISI 304/303, VA) _____

Mounting accessories see from page 208.

Adjuster Knob
DE-GAS-8
 See page 175.

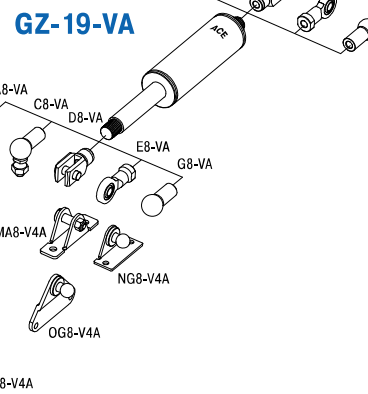

Technical Data

- Traction force:** 40 N to 350 N (extended up to 448 N)
- Progression:** Approx. 23 % to 28 %
- Lifetime:** Approx. 2,000 m
- Operating temperature range:** -20 °C to +80 °C
- Material:** Outer body, Piston rod, End fittings: stainless steel (1.4301/1.4305, AISI 304/303)
- Mounting:** with piston rod upwards
- End position damping length:** Without damping. For end position damping use damping material (e.g. TUBUS or SLAB).
- Positive stop:** External positive stop in the pulling direction provided by the customer.
- End fittings:** They are interchangeable and if necessary must be positively secured by the customer to prevent unscrewing.

Issue 07.2017 – Specifications subject to change