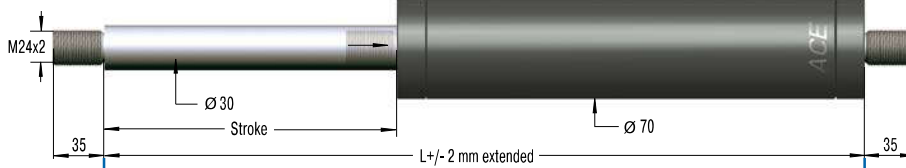
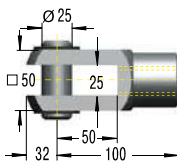
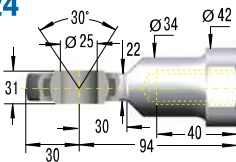
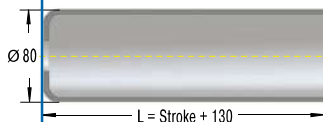

**End Fitting**
**Standard Dimensions**
**End Fitting**
**B24**

**Stud Thread B24**
**D24**

**Clevis Fork D24**  
max. force 50,000 N

**E24**

**Swivel Eye E24**  
max. force 50,000 N

**Rod Shroud W24-70**

**Performance and Dimensions**

TYPES	Stroke mm	L extended mm	Extension force max. N
GS-70-100	100	320	13,000
GS-70-200	200	520	13,000
GS-70-300	300	720	13,000
GS-70-400	400	920	13,000
GS-70-500	500	1,120	13,000
GS-70-600	600	1,320	13,000
GS-70-700	700	1,520	13,000
GS-70-800	800	1,720	11,550

**Ordering Example**
**GS-70-200-EE-8000**

Type (Push Type) \_\_\_\_\_  
 Body Ø (70 mm) \_\_\_\_\_  
 Stroke (200 mm) \_\_\_\_\_  
 Piston Rod End Fitting E24 \_\_\_\_\_  
 Body End Fitting E24 \_\_\_\_\_  
 Nominal Force F<sub>1</sub> 8000 N \_\_\_\_\_

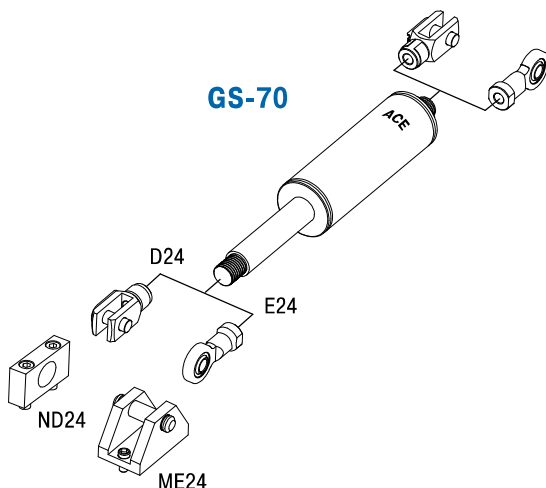
Mounting accessories see from page 200.

**Technical Data**
**Extension force:** 2,000 N to 13,000 N (compressed up to 16,250 N)

**Progression:** Approx. 25 %

**Operating temperature range:** -20 °C to +80 °C

**Material:** Outer body: coated steel; Piston rod: hard chrome plated steel; End fittings: zinc plated steel

**Mounting:** In any position. Hint: We recommend mounting with piston rod downwards to take advantage of the built-in end position damping.

**End position damping length:** approx. 10 mm to 20 mm (depending on the stroke)

**Positive stop:** External positive stop at the end of stroke provided by the customer.

**Note:** Increased break-away force if unit has not moved for some time.

**End fittings:** They are interchangeable and if necessary must be positively secured by the customer to prevent unscrewing.

**Safety instructions:** Gas springs (push type) should not be installed under pre-tension.