

Valve Technology, Stainless Steel, Extension force 500 N to 5,000 N (compressed up to 7,100 N)

End Fitting

Standard Dimensions

End Fitting

B14 Stud Thread B14

A14-VA Eye A14-VA max. force 7,000 N

C14-VA Angle Ball Joint C14-VA max. force 3,200 N

D14-VA Clevis Fork D14-VA max. force 7,000 N

E14-VA Swivel Eye E14-VA max. force 7,000 N

Adjuster Knob DE-GAS-14 See page 175.

Rod Shroud W14-40-VA

Ordering Example **GS-40-150-DD-3500-VA**

Type (Push Type) _____
 Body Ø (40 mm) _____
 Stroke (150 mm) _____
 Piston Rod End Fitting D14-VA _____
 Body End Fitting D14-VA _____
 Nominal Force F₁ 3500 N _____
 Material (1.4301/1.4305, AISI 304/303, VA) _____

TYPES	Stroke mm	L extended mm	Extension force max. N
GS-40-100-VA	100	317	5,000
GS-40-150-VA	150	417	5,000
GS-40-200-VA	200	517	5,000
GS-40-300-VA	300	717	5,000
GS-40-400-VA	400	917	5,000
GS-40-500-VA	500	1,117	5,000
GS-40-600-VA	600	1,317	4,150

Performance and Dimensions

Mounting accessories see from page 208.

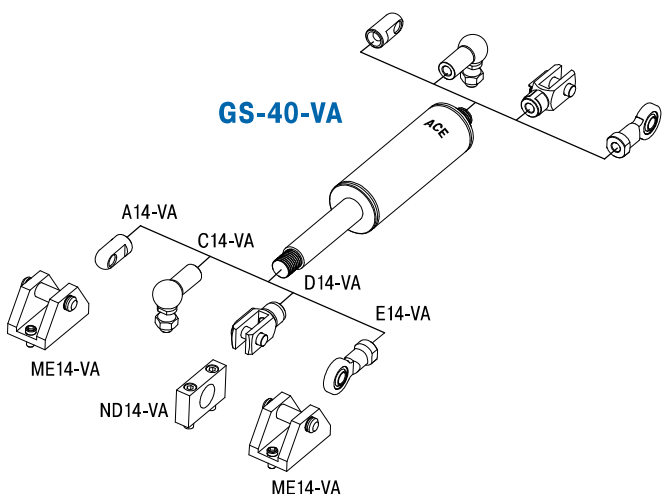

Technical Data

- Extension force:** 500 N to 5,000 N (compressed up to 7,100 N)
- Progression:** Approx. 34 % to 42 %
- Operating temperature range:** -20 °C to +80 °C
- Material:** Outer body, Piston rod, End fittings: stainless steel (1.4301/1.4305, AISI 304/303)
- Mounting:** We recommend mounting with piston rod downwards to take advantage of the built-in end position damping.
- End position damping length:** approx. 30 mm (depending on the stroke)
- Positive stop:** External positive stop at the end of stroke provided by the customer.
- Note:** Special oil according to FDA 21 CFR 178.3570 of the food industry
- End fittings:** They are interchangeable and if necessary must be positively secured by the customer to prevent unscrewing.
- Safety instructions:** Gas pressure springs should not be installed under pre-tension.

Issue 07.2017 – Specifications subject to change